

The Edging Experts

DATA SHEET

Edg-King™

5 INCH LAWN EDGING WITH A 1 INCH BEAD AND 4 GROOVE WALL ANCHOR

1-800-EDGINGS edgings@olyola.com
(334-4647) www.olyola.com

LANDSCAPE EDGING



Introduced in 1978, Edg-King™ was the first true professional grade edging. Still Oly-Ola's finest round top edging, Edg-King™ features four horizontal grooves on its anchoring wall which eliminates frost heaving problems and helps keep the edging in the ground. You need not worry about kinking or the additional labor costs that go along with it. Where others fail, Edg-King™ succeeds.

And, as with all Oly-Ola landscape edgings, Edg-King™ is made with high grade, recycled polyethylene, with no fillers or blown in materials. It is made to last!

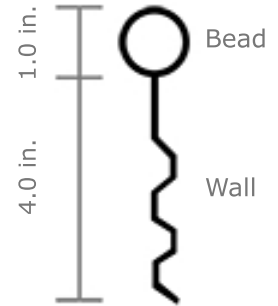

Available in 20 and 10 ft. lengths

SPECIFICATIONS	
Packaging:	20 foot - 5 pieces per flat bundle 10 foot - 5 pieces per flat bundle
Material:	Pure medium density polyethylene and 4% carbon black concentrate. Melt factor under 2
Average Wall Thickness:	.09 - .105 inches
Dimensions Per Piece:	Length: 20 ft. Height: 5 in.
Features:	1 in. round top bead 4 groove horizontal wall anchor
Can be Formed with Heat:	Yes - heat gun or propane torch (<i>No Contact</i>)
Connection Type:	King Connector (<i>Sold Separately</i>)
Staking:	Through edging wall at 45° angle using nail or Oly-Ola's 9.25 inch stake (<i>Sold Separately</i>)
Approx. Weight:	20 ft. piece: 6.8 lbs. 10 ft. piece: 3 lbs. 20 ft. bundle: 34 lbs. 10 ft. bundle: 15 lbs.



Installation Guidelines & Tips

BASICS

Dig a trench 5 inches deep along the lawn or bed edge. Place the edging in the trench and anchor it with stakes as indicated below. Use only Oly-Ola's exclusive crosslock connector when joining two lengths of edging together and be sure to use the overlap method pictured below.

STAKING

Pound a stake through the edging wall every 4 feet at a 45 degree angle. The stake should be installed at about the midway point of the wall. Pound the stake through the edging but **be sure to leave at least 2 inches undriven** to allow for resistance on both sides of the wall. Use extra stakes when securing joints and curves. Do not make the mistake of using too few stakes, especially when the ground is exposed to cold temperatures.

JOINING

Our unique crosslock connector is provided exclusively by Oly-Ola with our roundtop style edgings, except Trim-Line™. The fit of this connector can be adjusted by rotating it. When looking at the connector's end, it appears as a '+'. Inserted into the edging as a plus sign, this will give it a tighter fit. Rotate the plug 45 degrees and insert the plug as an 'X' and you will get a slightly looser fit.



CONNECTOR:
CROSSLCK

The Edg-King™ connector is not universal. Be sure to verify that the product stamp says 'King' before attempting to use with this edging.



▪ Avoid weak and unsightly joints by using the overlap method, and by using Oly-Ola's specifically engineered crosslock connector.

OVERLAP METHOD (FOR JOINING LENGTHS): Guard Against Gapping & Frost Heave

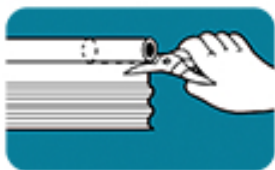

1. Cut off a 4 inch section of the round bead at the top of one of the edging pieces with a metal snip, utility knife or saw.

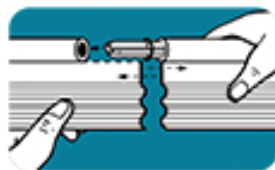

2. Use our exclusive crosslock connector to join the two sections, while overlapping the two pieces of edging.



3. Drive 1 or 2 steel anchoring stakes through both sections at a 45 degree angle toward the turf or outside portion of the bed.

Oly-Ola's 9.25 in. Non-bending Steel Stake

Discover
THE OLY-OLA
EDGE