

Super-Edg™

6 INCH LOW-PROFILE EDGING

Unlike any other edging on the market, Super-Edg™ features a 6 inch deep low-profile design that makes it ideal for a variety of landscape applications, such as: defining flower beds, forming logos and patterns and can be used above ground at the base of fences to save time and money while string trimming.

Super-Edg's heavy-duty, 100% recycled PVC construction makes it safer and more economical than metal edgings. Super-Edg™ is manufactured with pre-cut slots for staking and they are spaced every 2 feet. Oly-Ola provides 1 stake for every 2 holes with your purchase. If your design is elaborate or has lots of joints/curves, we recommend purchasing extra stakes. Super-Edg™ is made with 100% recycled, high grade PVC, without fillers or blown in materials. It is made to last!

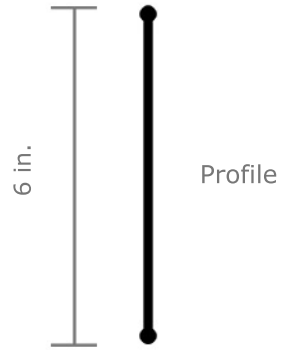

Available in 20 and 10 ft. lengths or 100 ft. roll

	SPECIFICATIONS
Packaging:	20 foot - 5 pieces per flat bundle 10 foot - 5 pieces per flat bundle 100 foot roll in carton (sold individually)
Each Piece Includes:	20 ft Edging, 5 steel stakes & 1 H-clip 10 ft Edging, 3 steel stakes & 1 H-clip 100 ft Edging, 25 steel stakes & 2 H-clips
Material:	Black rigid PVC, carbon black concentrate and impact modifier
Average Wall Thickness:	.115 - .130 inches
Dimensions Per Piece:	Length: 20 ft. Height: 6 in. Length: 10 ft. Height: 6 in.
Dimensions Per Carton:	28 in. X 28 in. X 7 in.
Connection Type:	H-Clip - Use PVC glue for permanent hold
Can be Formed with Heat:	Yes - heat gun or propane torch
Approx. Weight:	20 ft. piece: 8.6 lbs. 20 ft. bundle: 43 lbs. 10 ft. bundle: 22.5 lbs. Carton: 54 lbs. (includes stakes & H-clips)

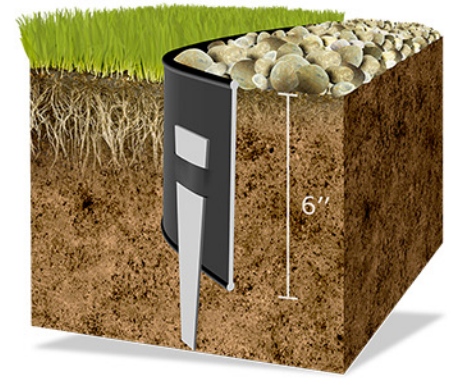

CONNECTOR: H-CLIP



The Black Jack™ connector is not universal. Be sure to verify that the product stamp says 'Jack' before attempting to use with this edging.

Installation Guidelines & Tips

BASICS

Dig a trench 6 inches deep along the lawn or bed edge. Place the edging in the trench and anchor it with stakes as indicated above. Use the provided connecting clip when joining two lengths of edging together and be sure to use the connecting method pictured below.

STAKING

Place a stake through the pre-cut slots parallel to the edging. The stake should be pounded until it will not go any further due to the width of the slot. Additional holes can be drilled to allow for extra stakes or spikes when securing joints and curves. Do not make the mistake of using too few stakes, especially when the ground is exposed to cold temperatures.

OVERLAP METHOD (FOR JOINING LENGTHS): Guard Against Gapping & Frost Heave



1. Using a hacksaw, cut both pieces of edging leaving a stake slot 3" from the end. Apply PVC cement to both sides of the edging, front and back

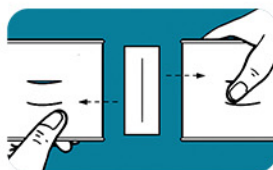

2. Use the connecting H-clip that comes with the edging to join the two sections. Do this quickly before the glue sets.

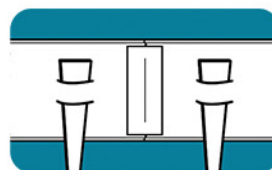

3. Drive the 14" steel anchoring stake through both sections using the pre-cut slots until the stake cannot go any deeper.

